

# Sales Offer



Thank you for your interest in Meraas Properties. Please find the details of property options.

Project	Unit	No of Bedrooms	Saleable Area (Sq ft)	Selling Price (AED)
Nourell	MJL-N1-102	2	1,342	5,512,000
e	MJL-N1-202	3	2,190	9,023,000
Nourell	MJL-N1-401	1	847	3,863,000
e	MJL-N1-406	1	845	3,854,000
Nourell	MJL-N1-501	1	897	3,989,000
e	MJL-N1-601	1	851	3,958,000
Nourell	MJL-N1-706	1	845	3,964,000
e	MJL-N1-805	1	1,043	4,195,000
Nourell	MJL-N1-1103	1	851	4,182,000
e	MJL-N1-004	2	1,484	5,451,000

Nourell

\* Applicable fees to Dubai Land Department of the property net price + AED 3,150 Oqood fee

\* Prices and availability are subject to change without notice

Nourell

Nourell	Bedrooms	2	Saleable Area (Sq ft)	1,342	
MJL-N1-102	Selling Price (AED)	5,512,000	Internal Area (Sq ft)	1,203	Plot Area (Sq ft)
e	Unit Type	2BR-T2E	Balcony Area (Sq ft)	140	

Nourell

## Standard Payment Plan

e

#Nourell	Milestone	%	Date	Amount (AED)
1e	Not Applicable	20.00%	20 Oct 2025	1,102,400
2	Not Applicable	10.00%	15 Mar 2026	551,200
3	Not Applicable	5.00%	15 Jul 2026	275,600
4	Not Applicable	10.00%	15 Dec 2026	551,200
5	Not Applicable	10.00%	15 May 2027	551,200
6	Not Applicable	10.00%	15 Oct 2027	551,200
7	Not Applicable	10.00%	15 Mar 2028	551,200
8	One Hundred (100%) percent of construction	25.00%	15 Jun 2029	1,378,000
			<b>Purchase Price</b>	<b>5,512,000</b>

# 2 - BEDROOM | TYPE B1-2E

# MADINAT JUMEIRAH LIVING

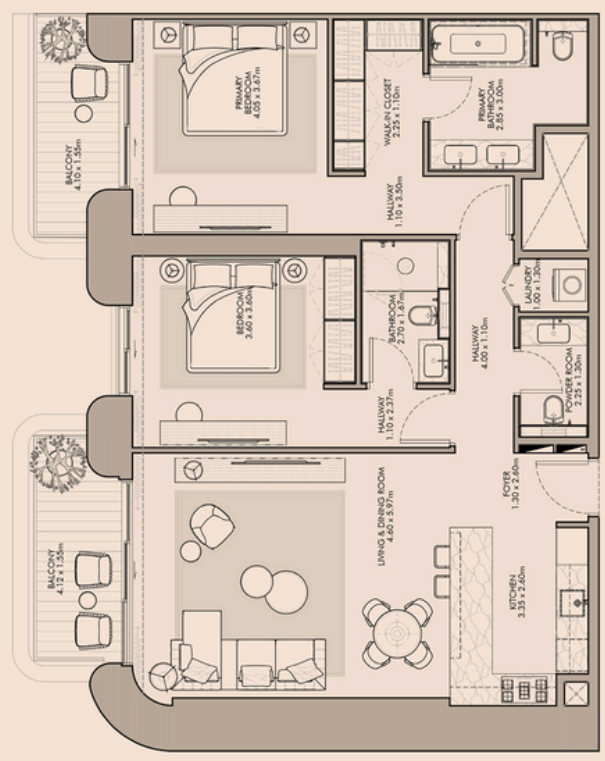
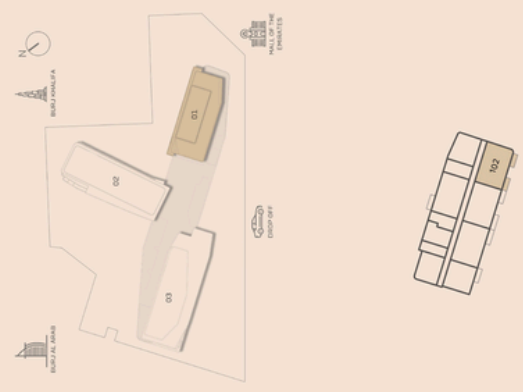

UNIT	SUITE AREA		BALCONY AREA		TOTAL AREA	
	SQM	SQFT	SQM	SQFT	SQM	SQFT
102	111.76	1202.97	12.96	139.50	124.72	1342.47

Disclaimer: Plans, details and unit orientation included are indicative only and are subject to change by the developer/seller at its sole discretion without notice and/or liability. All images, including features, finishes, furnishings, view and scale are illustrative only. Final areas, orientation, dimensions, layout and materials may differ from those stated.



Nouvelle MJL-N1-202	Bedrooms	3	Saleable Area (Sq ft)	2,190	
	Selling Price (AED)	9,023,000	Internal Area (Sq ft)	1,766	Plot Area (Sq ft)
	Unit Type	3BR-T3A	Balcony Area (Sq ft)	423	

### Standard Payment Plan

#	Milestone	%	Date	Amount (AED)
1	Not Applicable	20.00%	20 Oct 2025	1,804,600
2	Not Applicable	10.00%	15 Mar 2026	902,300
3	Not Applicable	5.00%	15 Jul 2026	451,150
4	Not Applicable	10.00%	15 Dec 2026	902,300
5	Not Applicable	10.00%	15 May 2027	902,300
6	Not Applicable	10.00%	15 Oct 2027	902,300
7	Not Applicable	10.00%	15 Mar 2028	902,300
8	One Hundred (100%) percent of construction	25.00%	15 Jun 2029	2,255,750
			<b>Purchase Price</b>	<b>9,023,000</b>

# MADINAT JUMEIRAH LIVING

# 3 - BEDROOM | TYPE B1-3A

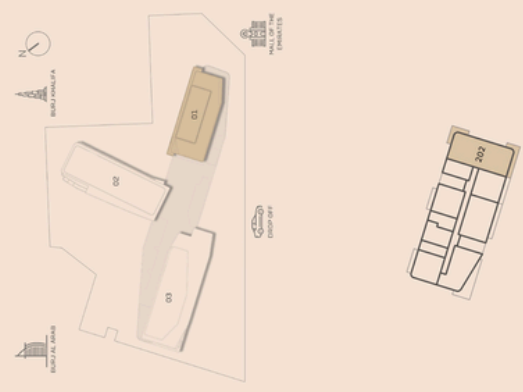

UNIT	SUITE AREA		BALCONY AREA		TOTAL AREA	
	SQM	SQFT	SQM	SQFT	SQM	SQFT
202	164.08	1766.14	39.34	423.45	203.42	2189.59

Disclaimer: Plans, details and unit orientation included are indicative only and are subject to change by the developer/seller at its sole discretion without notice and/or liability. All images, including features, finishes, furnishings, view and scale are illustrative only. Final areas, orientation, dimensions, layout and materials may differ from those stated.



Nouvelle MJL-N1-401	Bedrooms	1	Saleable Area (Sq ft)	847	
	Selling Price (AED)	3,863,000	Internal Area (Sq ft)	764	Plot Area (Sq ft)
	Unit Type	1BR-T1E	Balcony Area (Sq ft)	82	

### Standard Payment Plan

#	Milestone	%	Date	Amount (AED)
1	Not Applicable	20.00%	20 Oct 2025	772,600
2	Not Applicable	10.00%	15 Mar 2026	386,300
3	Not Applicable	5.00%	15 Jul 2026	193,150
4	Not Applicable	10.00%	15 Dec 2026	386,300
5	Not Applicable	10.00%	15 May 2027	386,300
6	Not Applicable	10.00%	15 Oct 2027	386,300
7	Not Applicable	10.00%	15 Mar 2028	386,300
8	One Hundred (100%) percent of construction	25.00%	15 Jun 2029	965,750
			<b>Purchase Price</b>	<b>3,863,000</b>

# MADINAT JUMEIRAH LIVING

## 1-BEDROOM | TYPE B1-1E

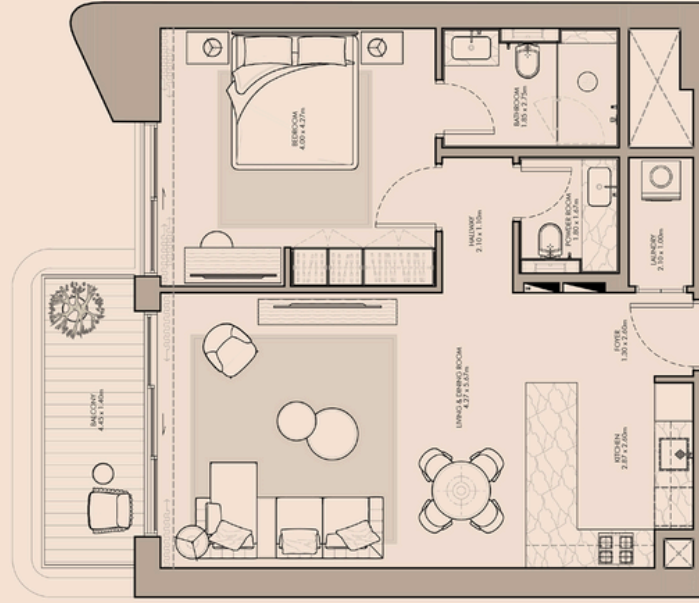

UNIT	SUITE AREA		BALCONY AREA		TOTAL AREA	
	SQM	SQFT	SQM	SQFT	SQM	SQFT
301, 401	71.02	764.45	7.65	82.34	78.67	846.8
901, 1001	71.04	764.67	7.65	82.34	78.69	847.01

Disclaimer: Plans, details and unit orientation included are indicative only and are subject to change by the developer/seller at its sole discretion without notice and/or liability. All images, including features, finishes, furnishings, view and scale are illustrative only. Final areas, orientation, dimensions, layout and materials may differ from those stated.



Nouvelle MJL-N1-406	Bedrooms	1	Saleable Area (Sq ft)	845	
	Selling Price (AED)	3,854,000	Internal Area (Sq ft)	763	Plot Area (Sq ft)
	Unit Type	1BR-T1G	Balcony Area (Sq ft)	82	

### Standard Payment Plan

#	Milestone	%	Date	Amount (AED)
1	Not Applicable	20.00%	20 Oct 2025	770,800
2	Not Applicable	10.00%	15 Mar 2026	385,400
3	Not Applicable	5.00%	15 Jul 2026	192,700
4	Not Applicable	10.00%	15 Dec 2026	385,400
5	Not Applicable	10.00%	15 May 2027	385,400
6	Not Applicable	10.00%	15 Oct 2027	385,400
7	Not Applicable	10.00%	15 Mar 2028	385,400
8	One Hundred (100%) percent of construction	25.00%	15 Jun 2029	963,500
			<b>Purchase Price</b>	<b>3,854,000</b>

# 1-BEDROOM | TYPE B1-1G

# MADINAT JUMEIRAH LIVING



UNIT	SUITE AREA		BALCONY AREA		TOTAL AREA	
	SQM	SQFT	SQM	SQFT	SQM	SQFT
306, 406	70.87	762.84	7.65	82.34	78.52	845.18
601, 701	71.4	768.54	7.65	82.34	79.05	850.89
606, 706	70.82	762.3	7.65	82.34	78.47	844.64
905	70.86	762.73	7.57	81.48	78.43	844.21
1005	71.1	765.31	7.57	81.48	78.67	846.8
1103	71.43	768.87	7.65	82.34	79.08	851.21

Disclaimer: Plans, details and unit orientation included are indicative only and are subject to change by the developer/seller at its sole discretion without notice and/or liability. All images, including features, finishes, furnishings, view and scale are illustrative only. Final areas, orientation, dimensions, layout and materials may differ from those stated.



Nouvelle MJL-N1-501	Bedrooms	1	Saleable Area (Sq ft)	897	
	Selling Price (AED)	3,989,000	Internal Area (Sq ft)	769	Plot Area (Sq ft)
	Unit Type	1BR-T1H	Balcony Area (Sq ft)	129	

### Standard Payment Plan

#	Milestone	%	Date	Amount (AED)
1	Not Applicable	20.00%	20 Oct 2025	797,800
2	Not Applicable	10.00%	15 Mar 2026	398,900
3	Not Applicable	5.00%	15 Jul 2026	199,450
4	Not Applicable	10.00%	15 Dec 2026	398,900
5	Not Applicable	10.00%	15 May 2027	398,900
6	Not Applicable	10.00%	15 Oct 2027	398,900
7	Not Applicable	10.00%	15 Mar 2028	398,900
8	One Hundred (100%) percent of construction	25.00%	15 Jun 2029	997,250
			<b>Purchase Price</b>	<b>3,989,000</b>

# MADINAT JUMEIRAH LIVING

## 1-BEDROOM | TYPE B1-1H

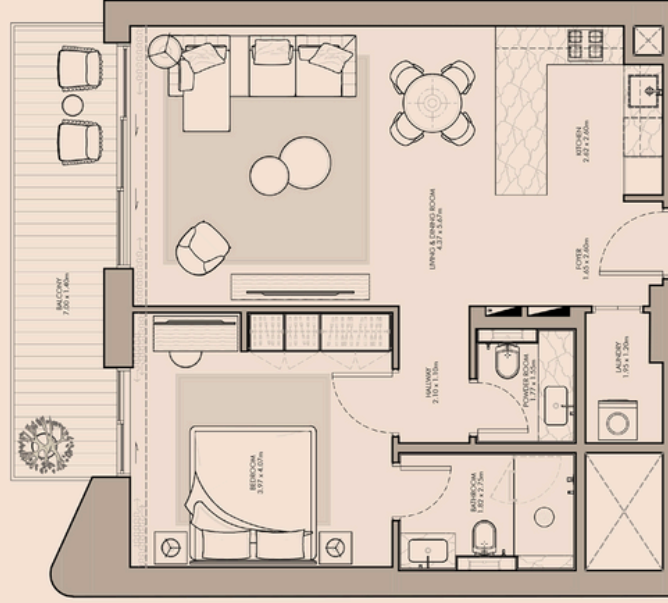
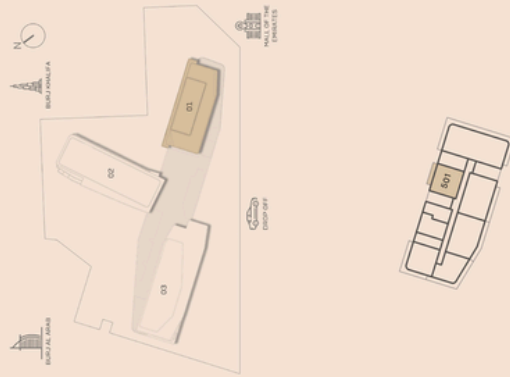

Disclaimer: Plans, details and unit orientation included are indicative only and are subject to change by the developer/seller at its sole discretion without notice and/or liability. All images, including features, finishes, furnishings, view and scale are illustrative only. Final areas, orientation, dimensions, layout and materials may differ from those stated.



UNIT	SUITE AREA		BALCONY AREA		TOTAL AREA	
	SQM	SQFT	SQM	SQFT	SQM	SQFT
501	71.4	766.54	11.95	128.63	83.35	897.17

Nouvelle MJL-N1-601	Bedrooms	1	Saleable Area (Sq ft)	851	
	Selling Price (AED)	3,958,000	Internal Area (Sq ft)	769	Plot Area (Sq ft)
	Unit Type	1BR-T1G	Balcony Area (Sq ft)	82	

### Standard Payment Plan

#	Milestone	%	Date	Amount (AED)	
1	Not Applicable	20.00%	20 Oct 2025	791,600	
2	Not Applicable	10.00%	15 Mar 2026	395,800	
3	Not Applicable	5.00%	15 Jul 2026	197,900	
4	Not Applicable	10.00%	15 Dec 2026	395,800	
5	Not Applicable	10.00%	15 May 2027	395,800	
6	Not Applicable	10.00%	15 Oct 2027	395,800	
7	Not Applicable	10.00%	15 Mar 2028	395,800	
8	One Hundred (100%) percent of construction	25.00%	15 Jun 2029	989,500	
				<b>Purchase Price</b>	<b>3,958,000</b>

# MADINAT JUMEIRAH LIVING

# 1-BEDROOM | TYPE B1-1G



UNIT	SUITE AREA		BALCONY AREA		TOTAL AREA	
	SQM	SQFT	SQM	SQFT	SQM	SQFT
306, 406	70.87	762.84	7.65	82.34	78.52	845.18
601, 701	71.4	768.54	7.65	82.34	79.05	850.89
606, 706	70.82	762.3	7.65	82.34	78.47	844.64
905	70.86	762.73	7.57	81.48	78.43	844.21
1005	71.1	765.31	7.57	81.48	78.67	846.8
1103	71.43	766.87	7.65	82.34	79.08	851.21

Disclaimer: Plans, details and unit orientation included are indicative only and are subject to change by the developer/seller at its sole discretion without notice and/or liability. All images, including features, finishes, furnishings, view and scale are illustrative only. Final areas, orientation, dimensions, layout and materials may differ from those stated.



Nouvelle MJL-N1-706	Bedrooms	1	Saleable Area (Sq ft)	845	
	Selling Price (AED)	3,964,000	Internal Area (Sq ft)	762	Plot Area (Sq ft)
	Unit Type	1BR-T1G	Balcony Area (Sq ft)	82	

### Standard Payment Plan

#	Milestone	%	Date	Amount (AED)
1	Not Applicable	20.00%	20 Oct 2025	792,800
2	Not Applicable	10.00%	15 Mar 2026	396,400
3	Not Applicable	5.00%	15 Jul 2026	198,200
4	Not Applicable	10.00%	15 Dec 2026	396,400
5	Not Applicable	10.00%	15 May 2027	396,400
6	Not Applicable	10.00%	15 Oct 2027	396,400
7	Not Applicable	10.00%	15 Mar 2028	396,400
8	One Hundred (100%) percent of construction	25.00%	15 Jun 2029	991,000
			<b>Purchase Price</b>	<b>3,964,000</b>

# MADINAT JUMEIRAH LIVING

## 1-BEDROOM | TYPE B1-1G



UNIT	SUITE AREA		BALCONY AREA		TOTAL AREA	
	SQM	SQFT	SQM	SQFT	SQM	SQFT
306, 406	70.87	762.84	7.65	82.34	78.52	845.18
601, 701	71.4	768.54	7.65	82.34	79.05	850.89
606, 706	70.82	762.3	7.65	82.34	78.47	844.64
905	70.86	762.73	7.57	81.48	78.43	844.21
1005	71.1	765.31	7.57	81.48	78.67	846.8
1103	71.43	766.87	7.65	82.34	79.08	851.21

Disclaimer: Plans, details and unit orientation included are indicative only and are subject to change by the developer/seller at its sole discretion without notice and/or liability. All images, including features, finishes, furnishings, view and scale are illustrative only. Final areas, orientation, dimensions, layout and materials may differ from those stated.



Nouvelle MJL-N1-805	Bedrooms	1	Saleable Area (Sq ft)	1,043	
	Selling Price (AED)	4,195,000	Internal Area (Sq ft)	763	Plot Area (Sq ft)
	Unit Type	1BR-T1J	Balcony Area (Sq ft)	280	

### Standard Payment Plan

#	Milestone	%	Date	Amount (AED)
1	Not Applicable	20.00%	20 Oct 2025	839,000
2	Not Applicable	10.00%	15 Mar 2026	419,500
3	Not Applicable	5.00%	15 Jul 2026	209,750
4	Not Applicable	10.00%	15 Dec 2026	419,500
5	Not Applicable	10.00%	15 May 2027	419,500
6	Not Applicable	10.00%	15 Oct 2027	419,500
7	Not Applicable	10.00%	15 Mar 2028	419,500
8	One Hundred (100%) percent of construction	25.00%	15 Jun 2029	1,048,750
			<b>Purchase Price</b>	<b>4,195,000</b>

# MADINAT JUMEIRAH LIVING

## 1-BEDROOM | TYPE B1-1J

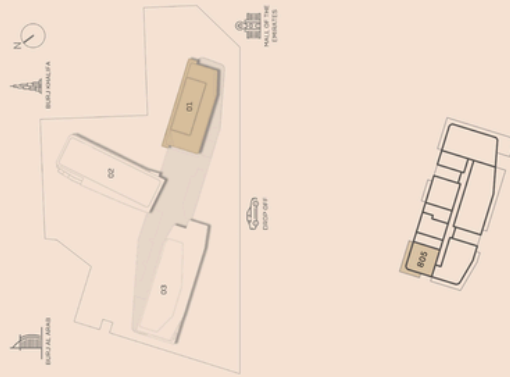

Disclaimer: Plans, details and unit orientation included are indicative only and are subject to change by the developer/seller at its sole discretion without notice and/or liability. All images, including features, finishes, furnishings, view and scale are illustrative only. Final areas, orientation, dimensions, layout and materials may differ from those stated.



UNIT	SUITE AREA		BALCONY AREA		TOTAL AREA	
	SQM	SQFT	SQM	SQFT	SQM	SQFT
805	70.86	76273	26	279.66	96.86	1042.59

Nouvelle MJL-N1-1103	Bedrooms	1	Saleable Area (Sq ft)	851	
	Selling Price (AED)	4,182,000	Internal Area (Sq ft)	769	Plot Area (Sq ft)
	Unit Type	1BR-T1G	Balcony Area (Sq ft)	82	

### Standard Payment Plan

#	Milestone	%	Date	Amount (AED)
1	Not Applicable	20.00%	20 Oct 2025	836,400
2	Not Applicable	10.00%	15 Mar 2026	418,200
3	Not Applicable	5.00%	15 Jul 2026	209,100
4	Not Applicable	10.00%	15 Dec 2026	418,200
5	Not Applicable	10.00%	15 May 2027	418,200
6	Not Applicable	10.00%	15 Oct 2027	418,200
7	Not Applicable	10.00%	15 Mar 2028	418,200
8	One Hundred (100%) percent of construction	25.00%	15 Jun 2029	1,045,500
			<b>Purchase Price</b>	<b>4,182,000</b>

# MADINAT JUMEIRAH LIVING

## 1-BEDROOM | TYPE B1-1G

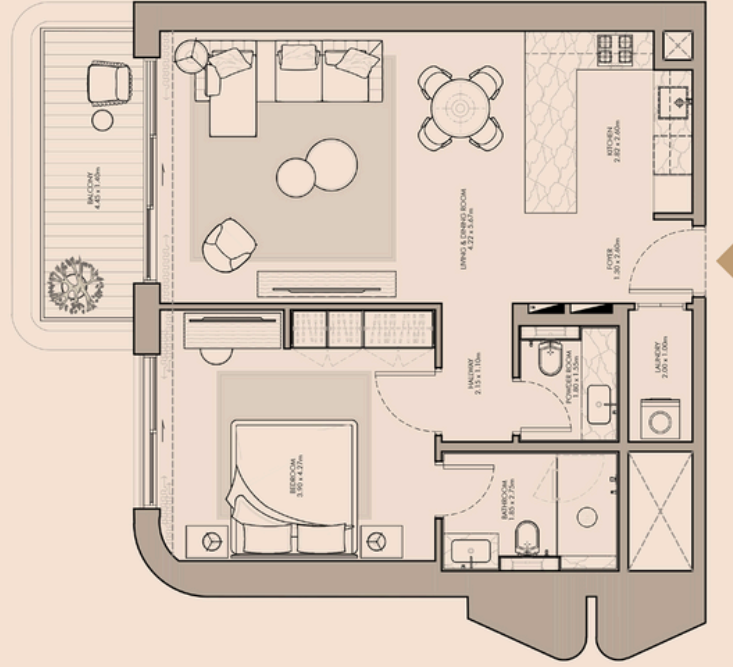

UNIT	SUITE AREA		BALCONY AREA		TOTAL AREA	
	SQM	SQFT	SQM	SQFT	SQM	SQFT
306, 406	70.87	762.84	7.65	82.34	78.52	845.18
601, 701	71.4	768.54	7.65	82.34	79.05	850.89
606, 706	70.82	762.3	7.65	82.34	78.47	844.64
905	70.86	762.73	7.57	81.48	78.43	844.21
1005	71.1	765.31	7.57	81.48	78.67	846.8
1103	71.43	766.87	7.65	82.34	79.08	851.21

Disclaimer: Plans, details and unit orientation included are indicative only and are subject to change by the developer/seller at its sole discretion without notice and/or liability. All images, including features, finishes, furnishings, view and scale are illustrative only. Final areas, orientation, dimensions, layout and materials may differ from those stated.



Nouvelle MJL-N1-004	Bedrooms	2	Saleable Area (Sq ft)	1,484	
	Selling Price (AED)	5,451,000	Internal Area (Sq ft)	1,196	Plot Area (Sq ft)
	Unit Type	2BR-T2B	Balcony Area (Sq ft)	288	

### Standard Payment Plan

#	Milestone	%	Date	Amount (AED)
1	Not Applicable	20.00%	20 Oct 2025	1,090,200
2	Not Applicable	10.00%	15 Mar 2026	545,100
3	Not Applicable	5.00%	15 Jul 2026	272,550
4	Not Applicable	10.00%	15 Dec 2026	545,100
5	Not Applicable	10.00%	15 May 2027	545,100
6	Not Applicable	10.00%	15 Oct 2027	545,100
7	Not Applicable	10.00%	15 Mar 2028	545,100
8	One Hundred (100%) percent of construction	25.00%	15 Jun 2029	1,362,750
			<b>Purchase Price</b>	<b>5,451,000</b>

# 2 - BEDROOM | TYPE B1-2B

# MADINAT JUMEIRAH LIVING

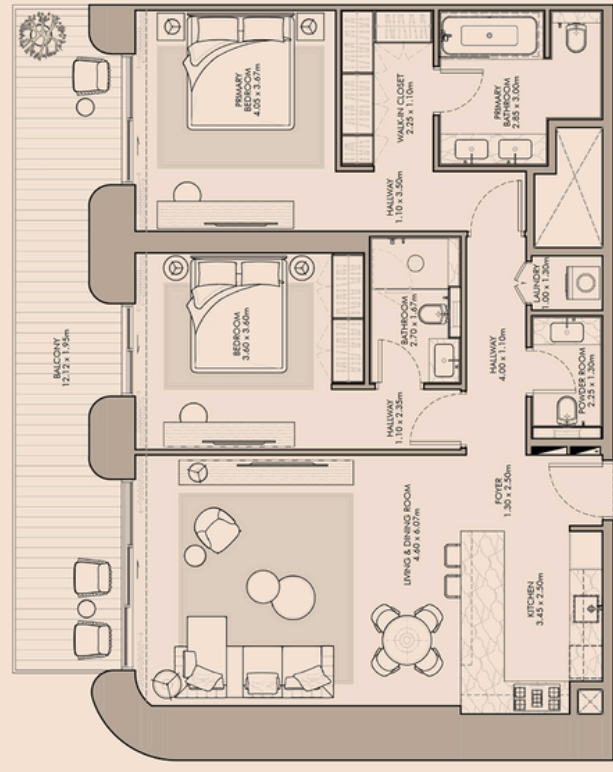
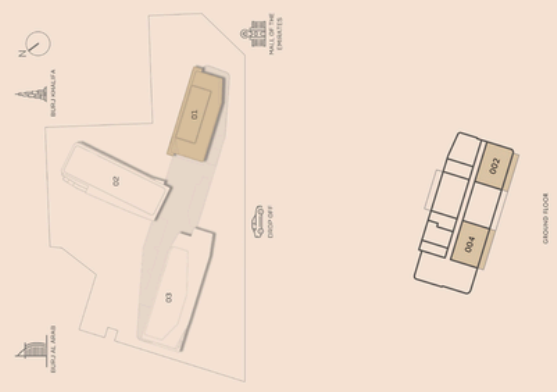

UNIT	SUITE AREA		BALCONY AREA		TOTAL AREA	
	SQM	SQFT	SQM	SQFT	SQM	SQFT
002	111.82	1203.62	25.21	271.36	137.03	1474.98
004	111.07	1195.55	26.78	288.26	137.85	1483.8

Disclaimer: Plans, details and unit orientation included are indicative only and are subject to change by the developer/seller at its sole discretion without notice and/or liability. All images, including features, finishes, furnishings, view and scale are illustrative only. Final areas, orientation, dimensions, layout and materials may differ from those stated.





**MAISON EDGE REALTY**  
REAL ESTATE BROKERAGE COMPANY

**SECURE YOUR UNIT**

 **+971551785800**